

**sbp**  
schlaich  
bergemann partner

mit Muhs Landschaftsarchitekten  
für die Freie und Hansestadt Hamburg

# Brückenschlag - Alter Elbpark

Hamburg, 3. Februar 2016

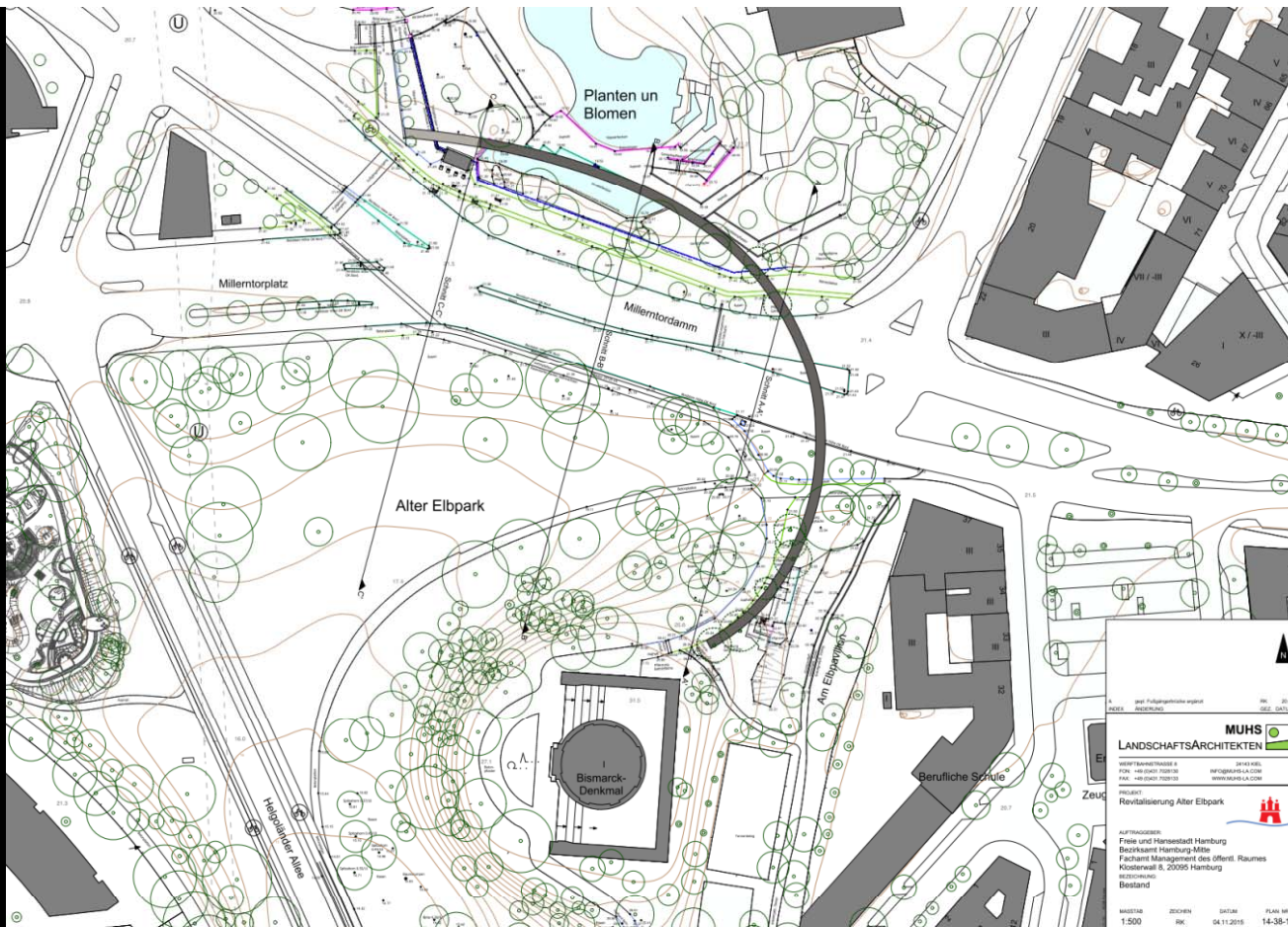

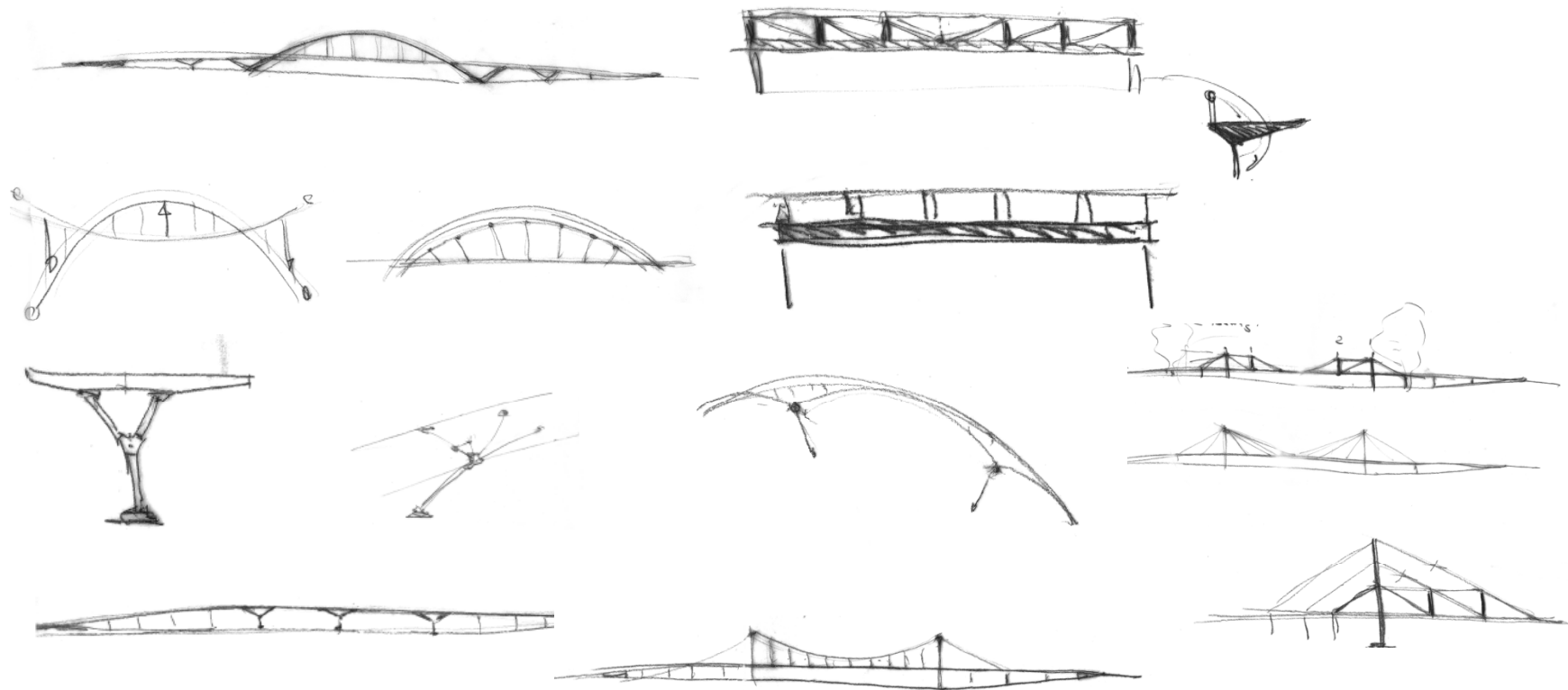

1



2

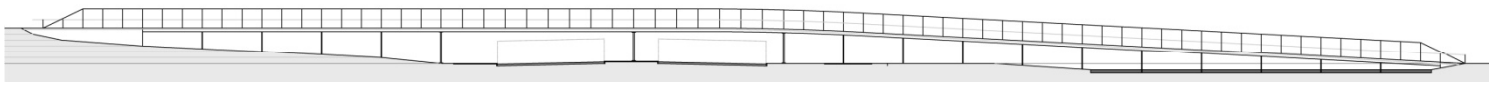

3

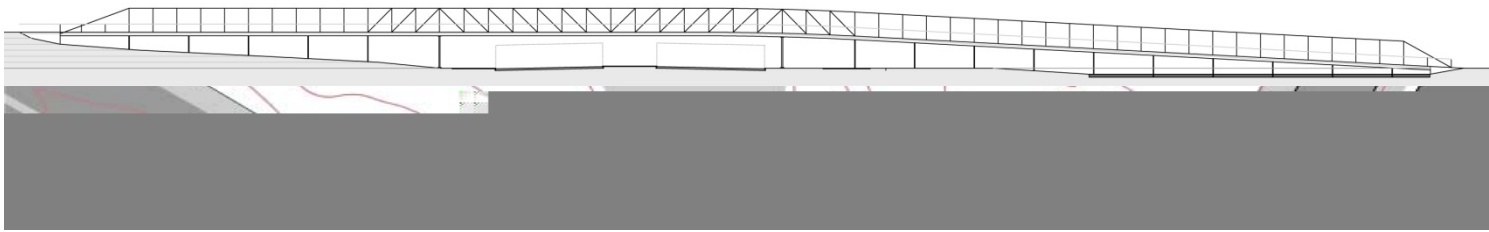

4



5

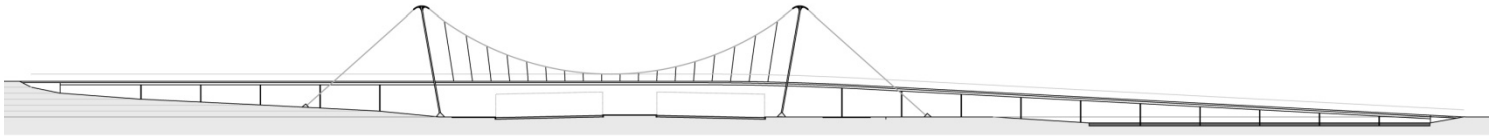

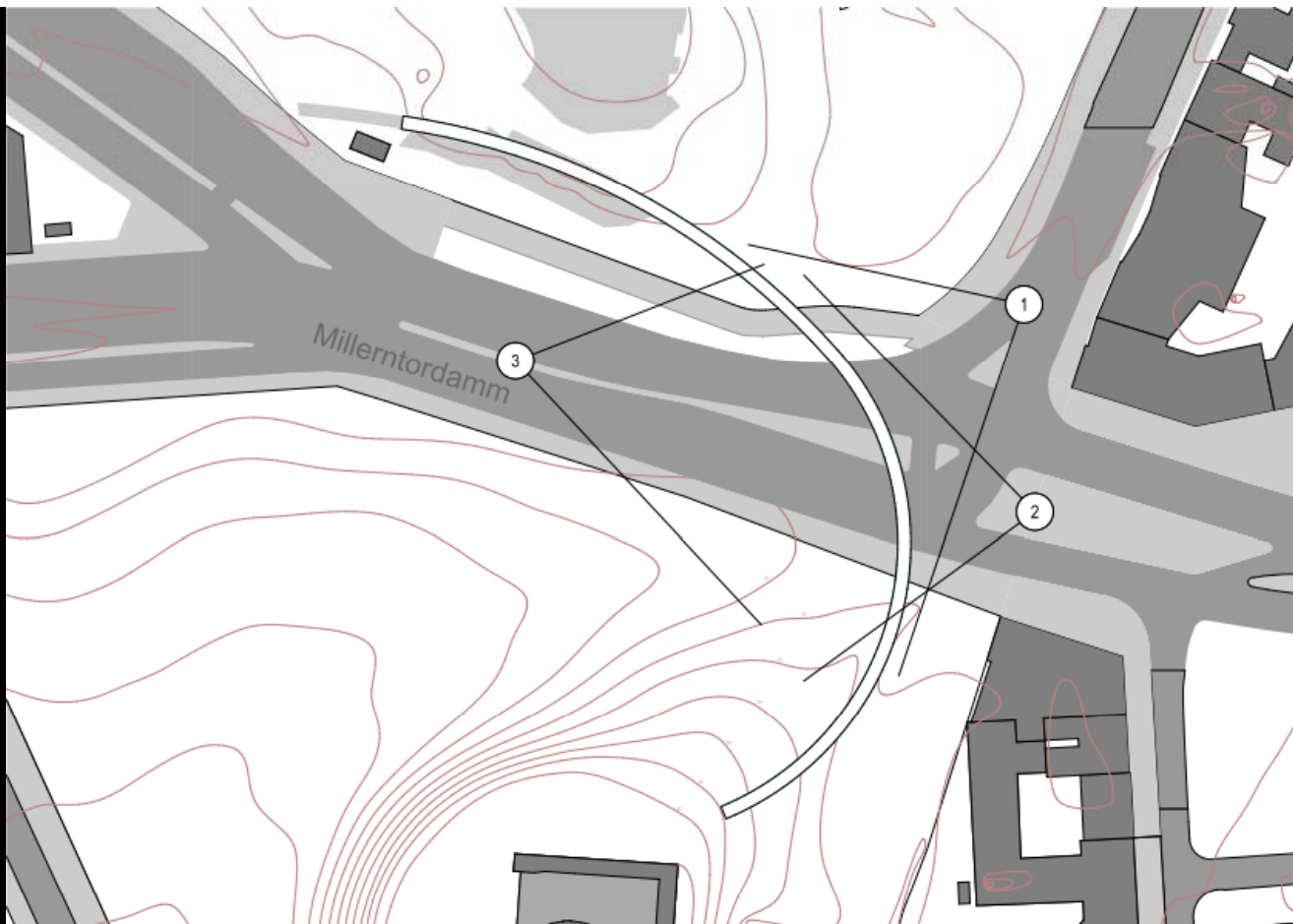

1

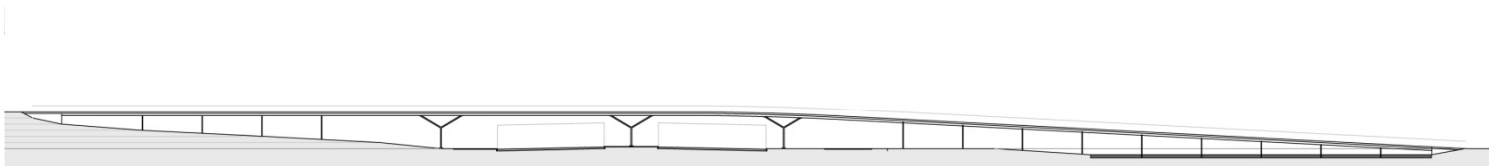

2

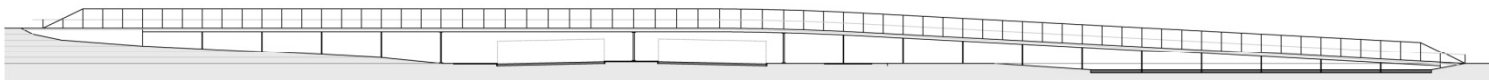

3

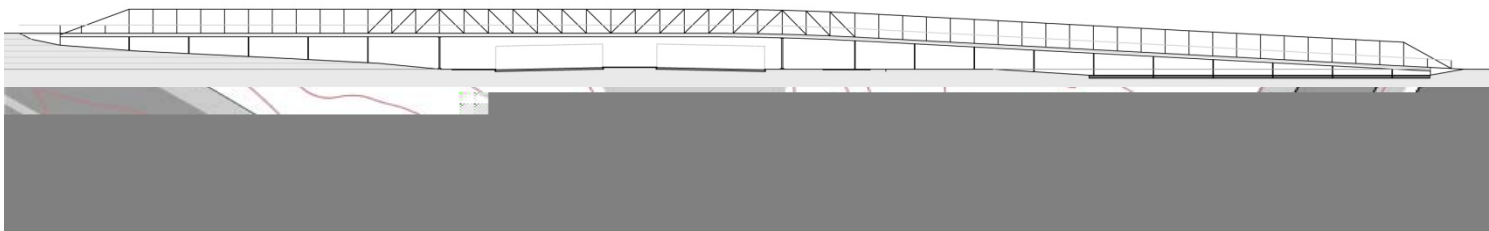

4



5

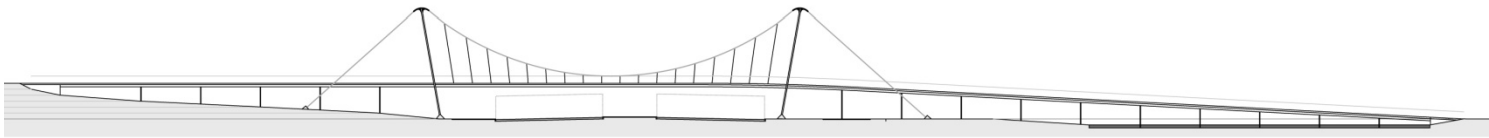



**sbp**  
schlaich  
bergemann partner

Konzept 1 - Baumstützen - IGA 1993 Pragsattel Pragstraße, Stuttgart, 1992



**sbp**  
schlach  
bergemann partner

Konzept 1 - Baustützen - Detail



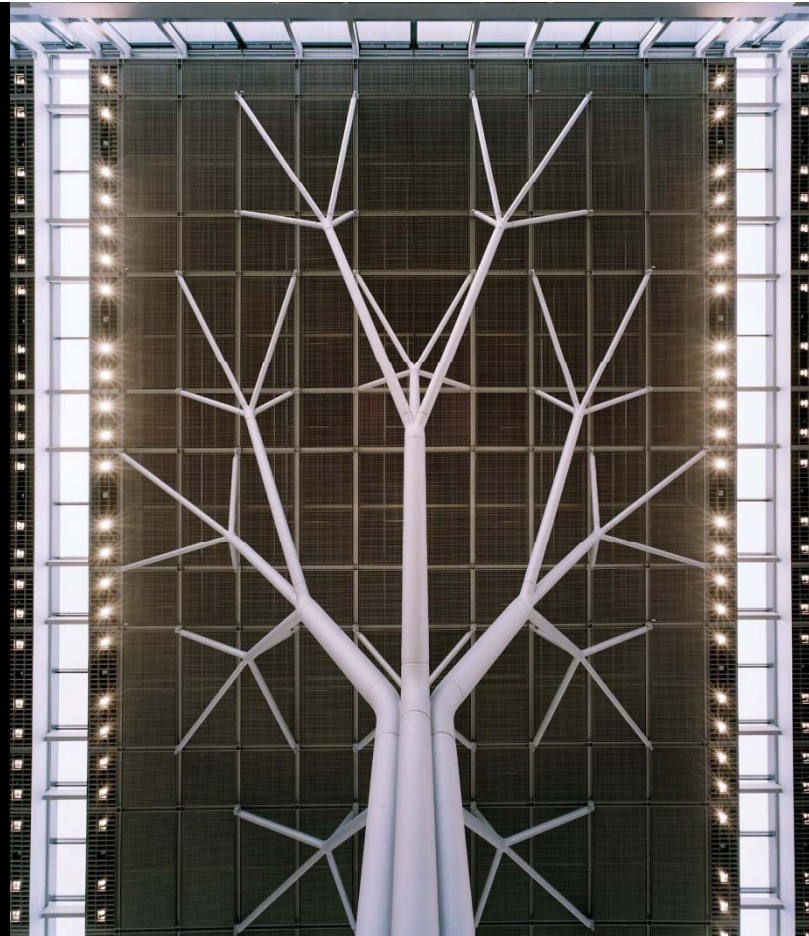

**sbp**  
schlaich  
bergemann partner

Konzept 1 - Baumstützen - Flughafen Stuttgart, Terminal 3, 2004



**sbp**  
schlach  
bergemann partner

Das gerade Brückendeck

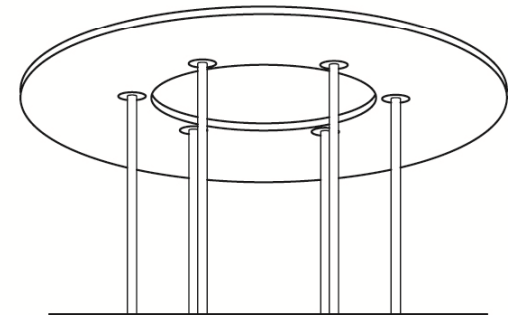
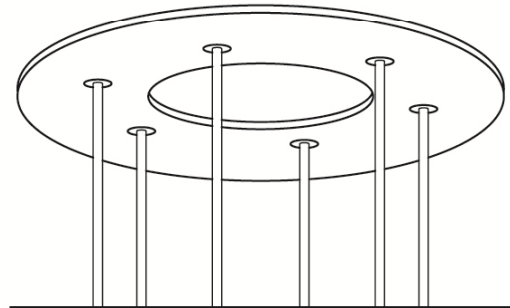
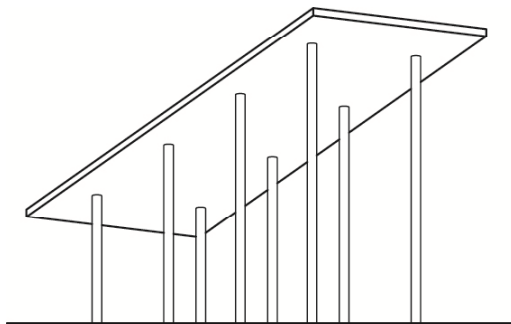

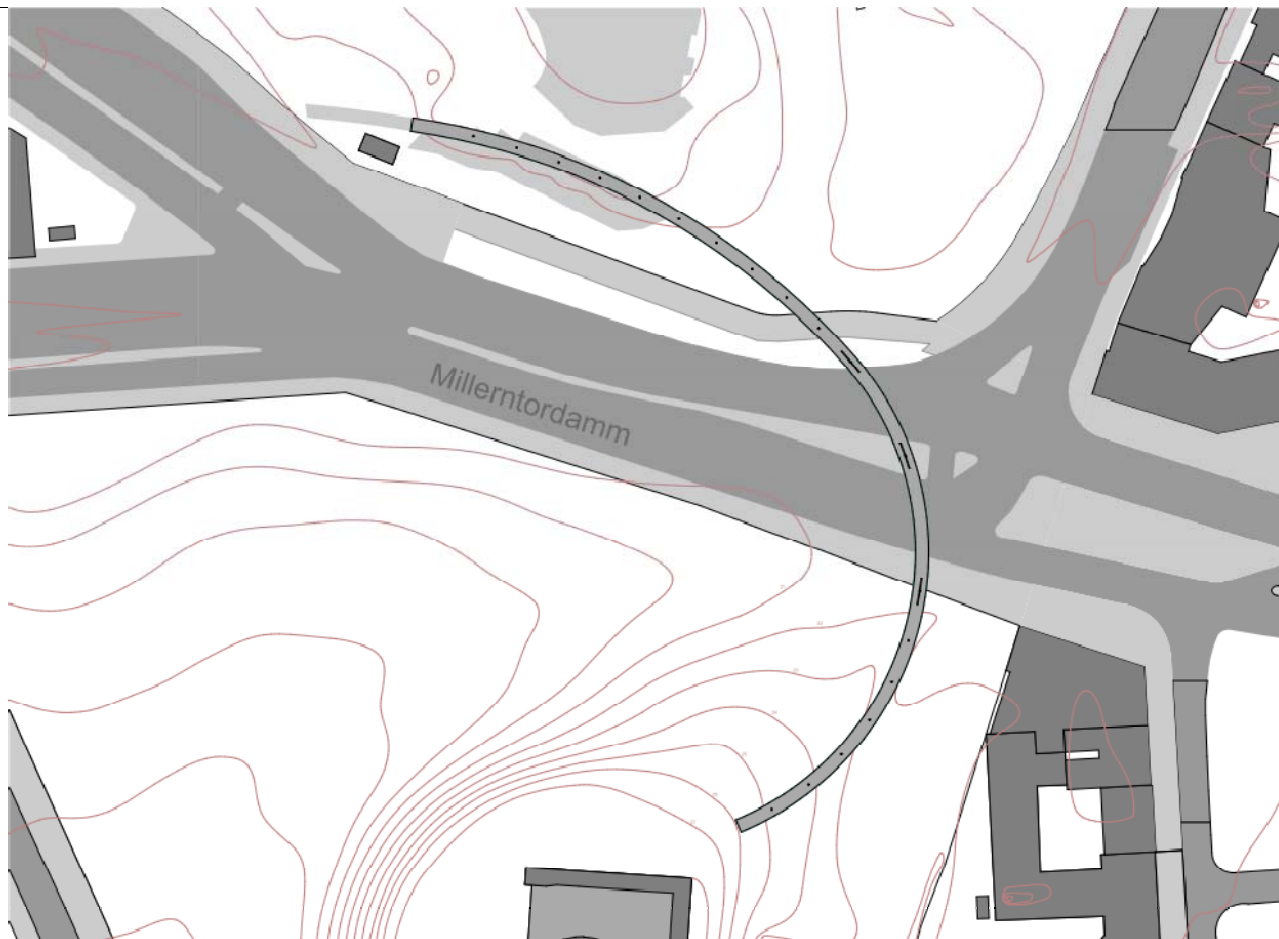



**sbp**  
schlach  
bergemann partner

Konzept 1 - Baumstützen – Perspektive 1



**sbp**  
schlach  
bergemann partner

Konzept 1 - Baumstützen – Perspektive 2



**sbp**  
schleich  
bergemann partner

Konzept 1 - Baumstützen – Perspektive 3

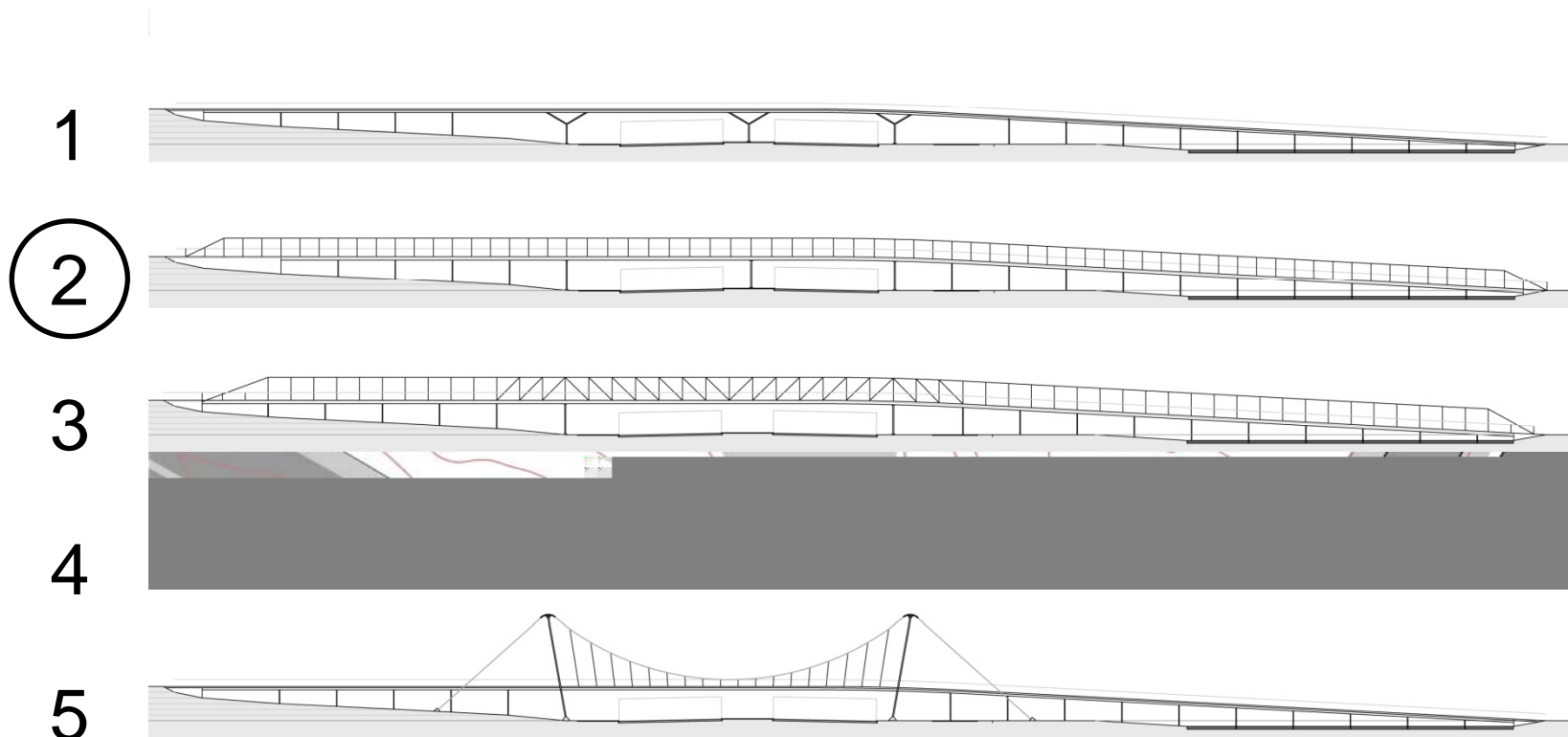



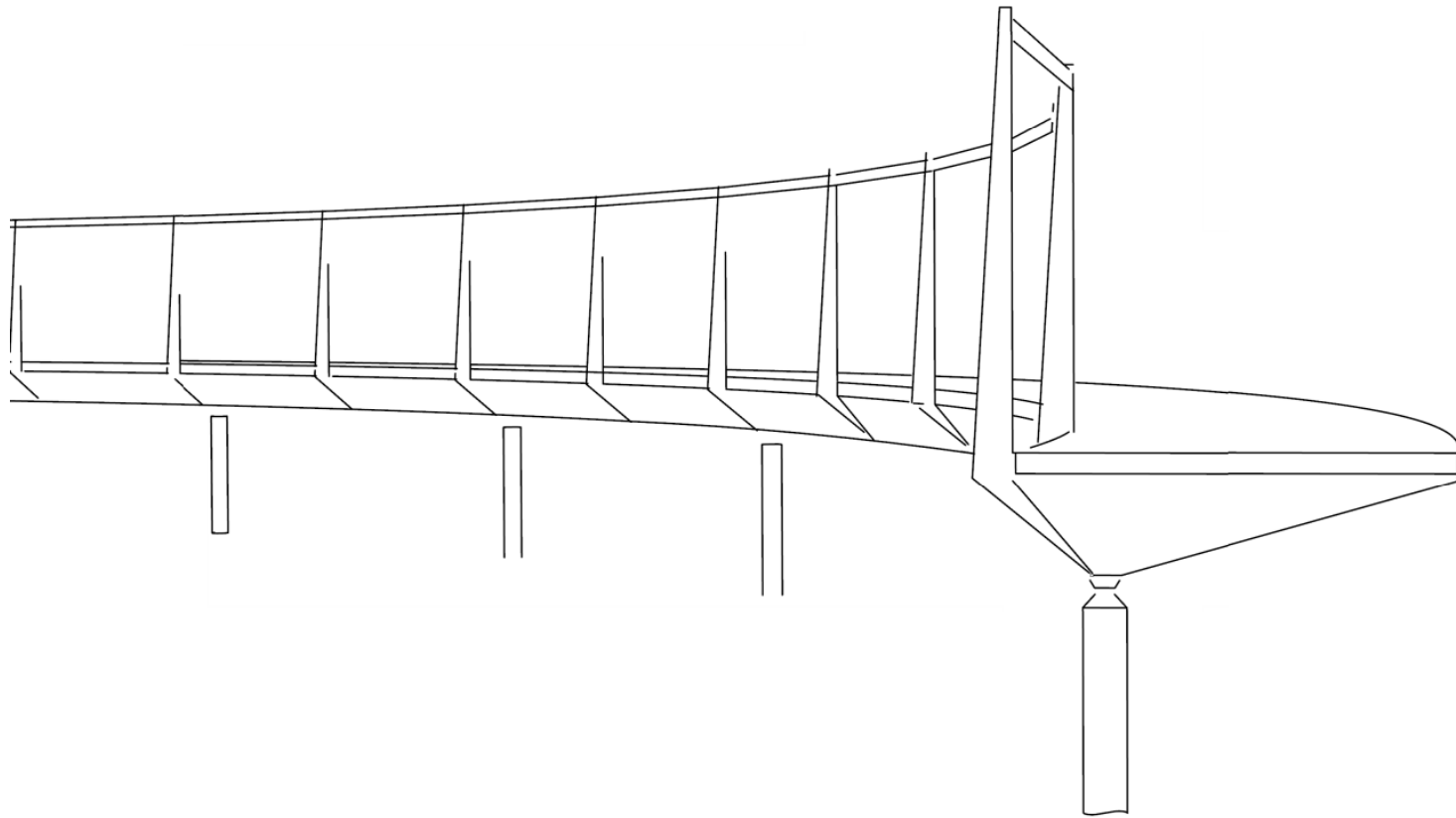

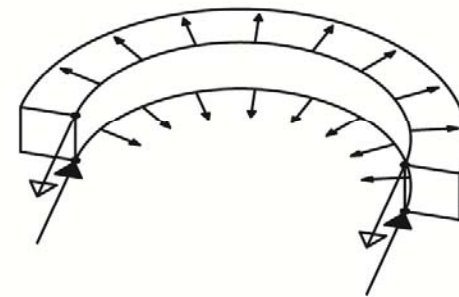
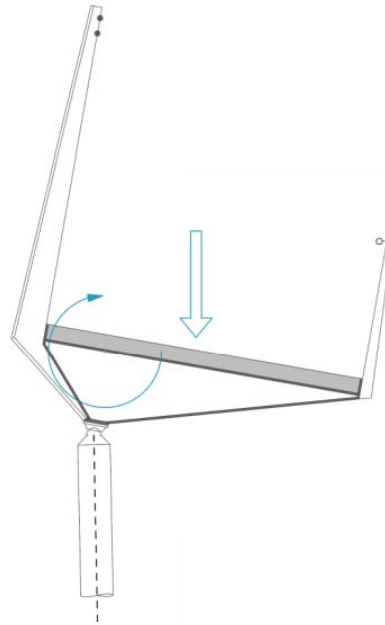
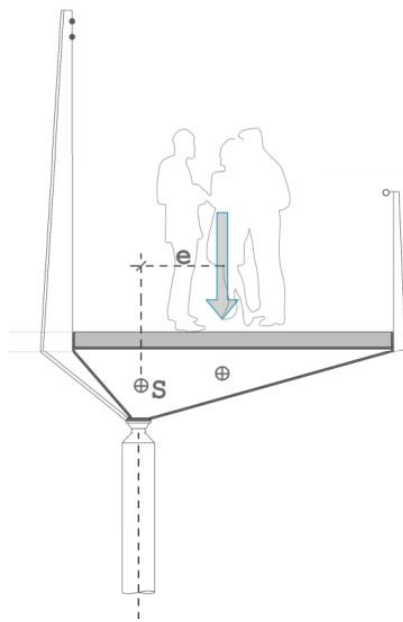

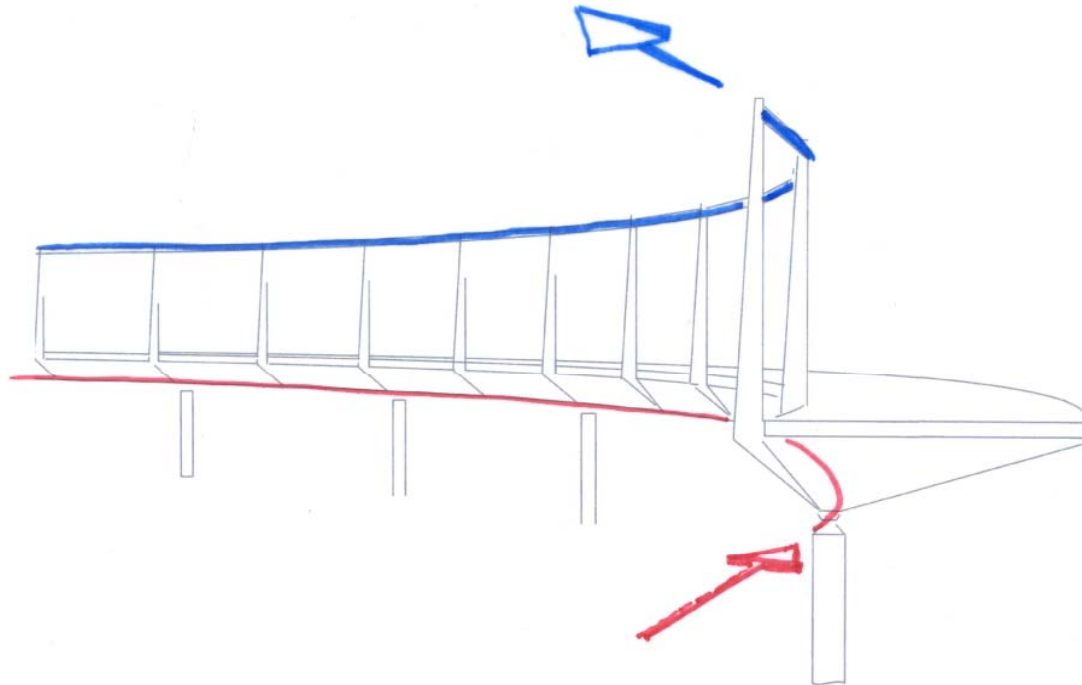
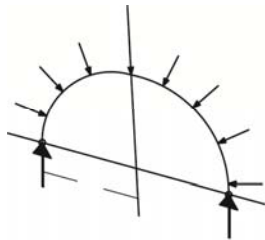
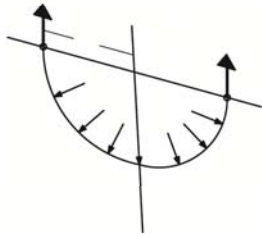
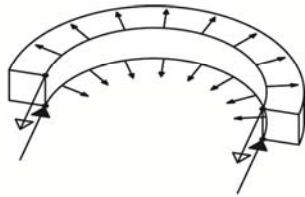

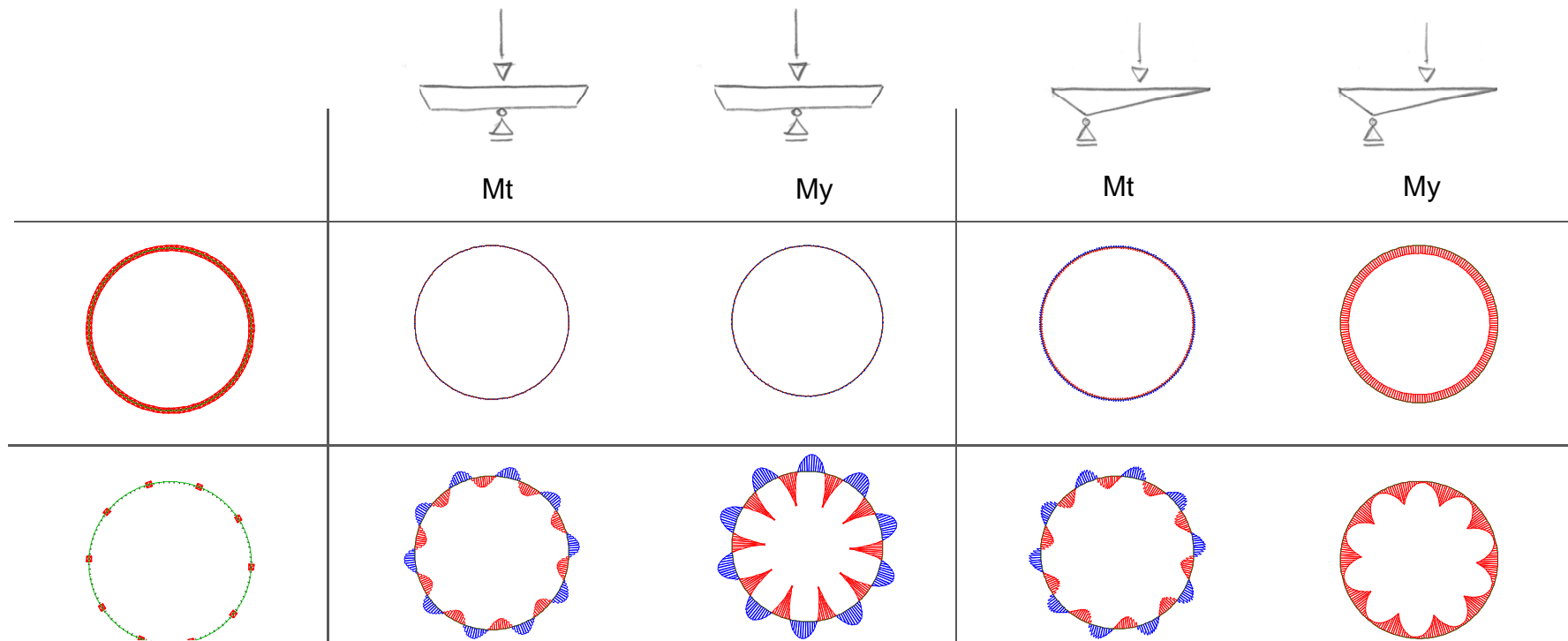

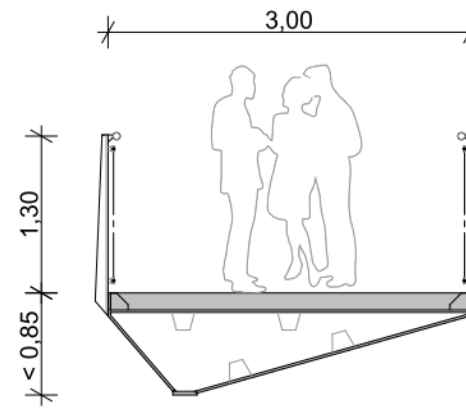
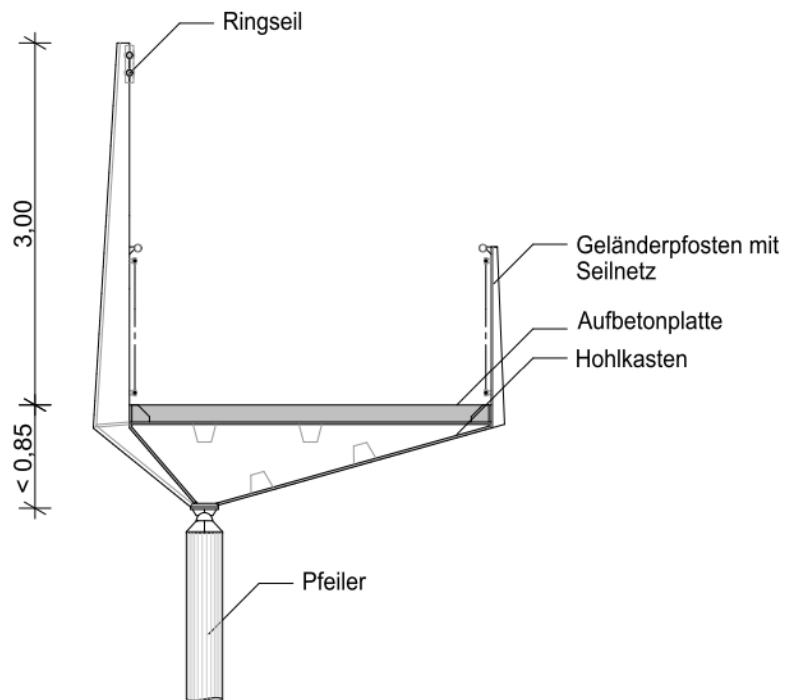

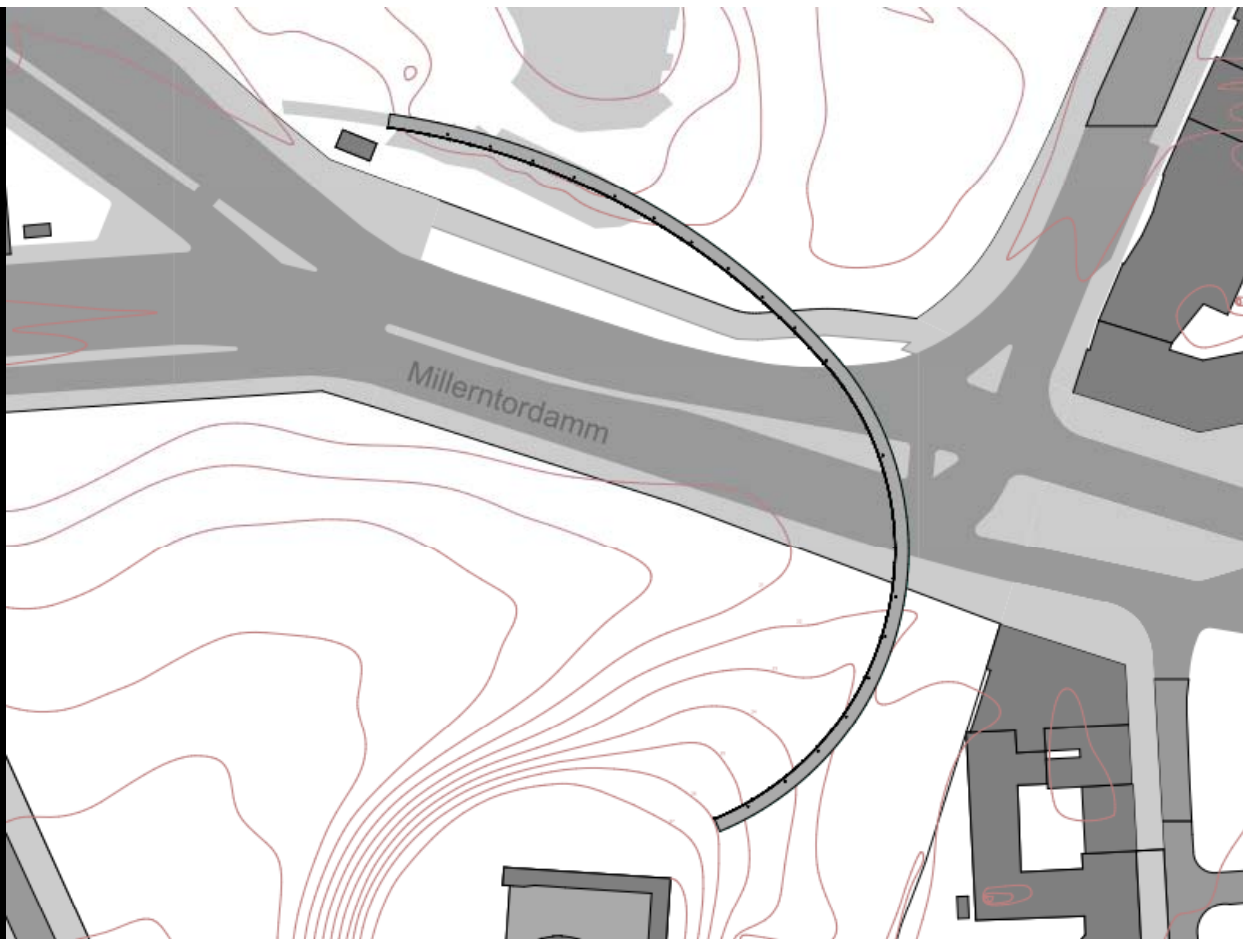



**sbp**  
schleich  
bergemann partner

Konzept 2 - Ringträger – Perspektive 1



**sbp**  
schlach  
bergemann partner

Konzept 2 - Ringträger – Perspektive 2





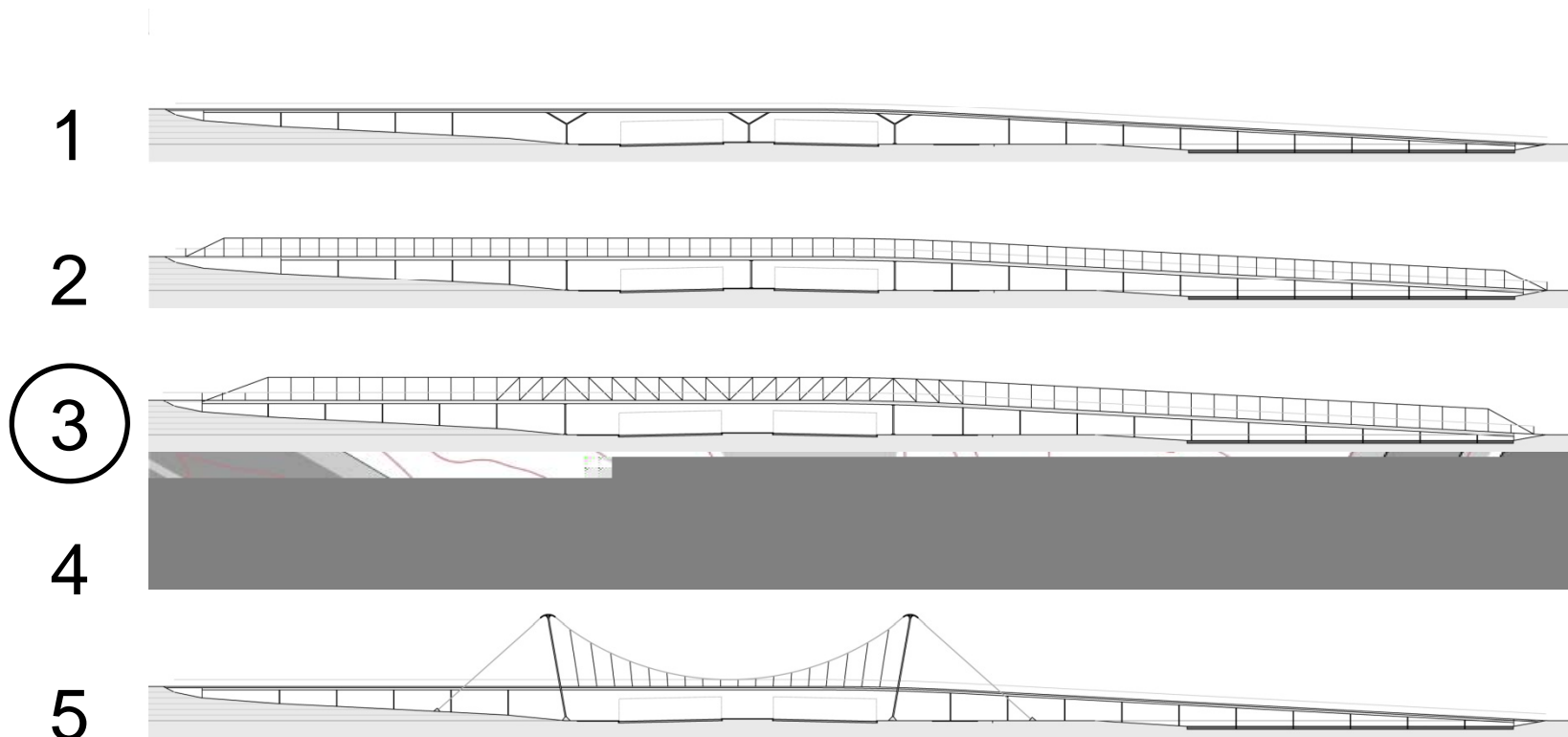

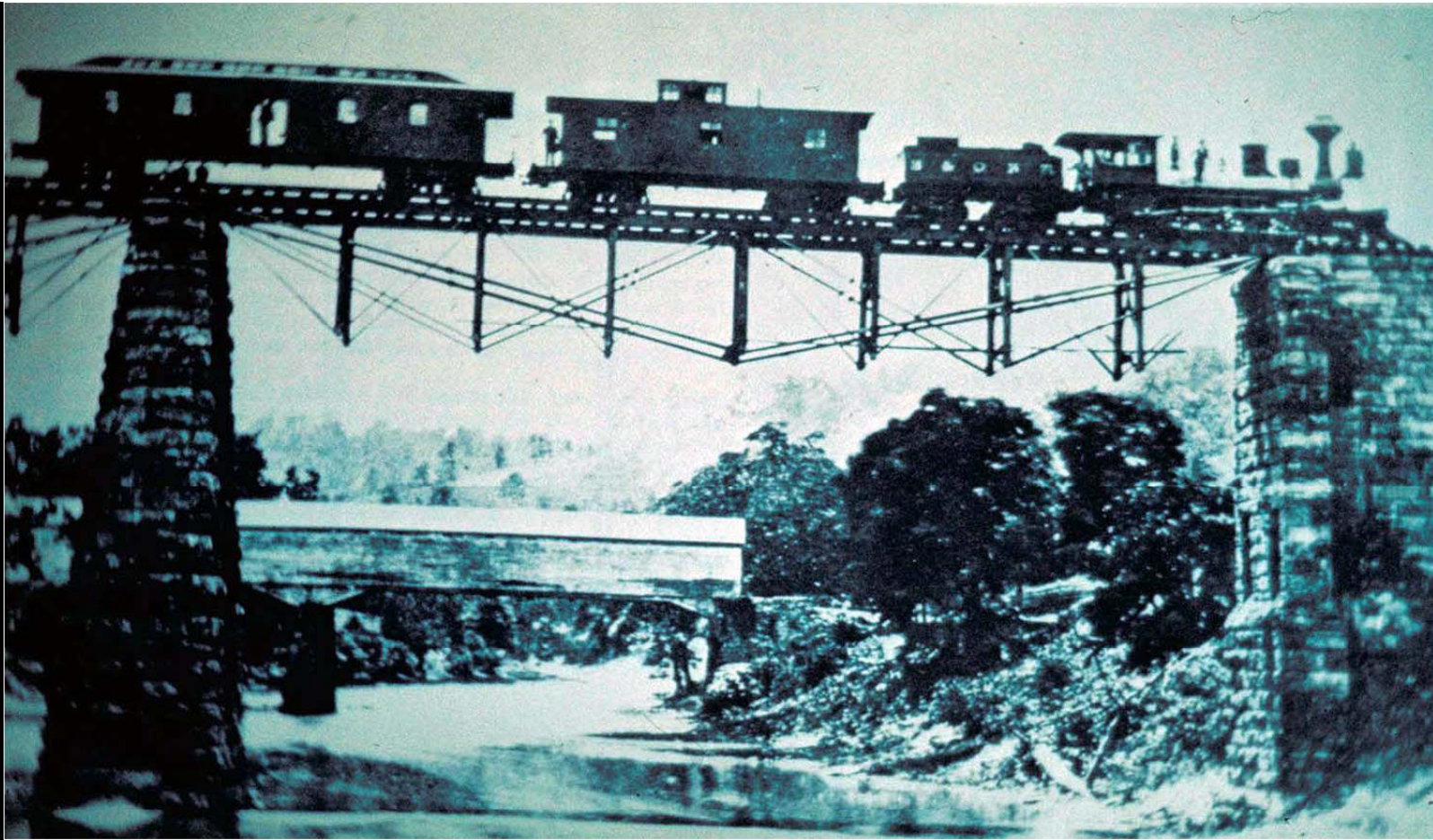

**sbp**  
schlaich  
bergemann partner

zu Konzept 3 - Fink-Fachwerk, USA, ca. 1875

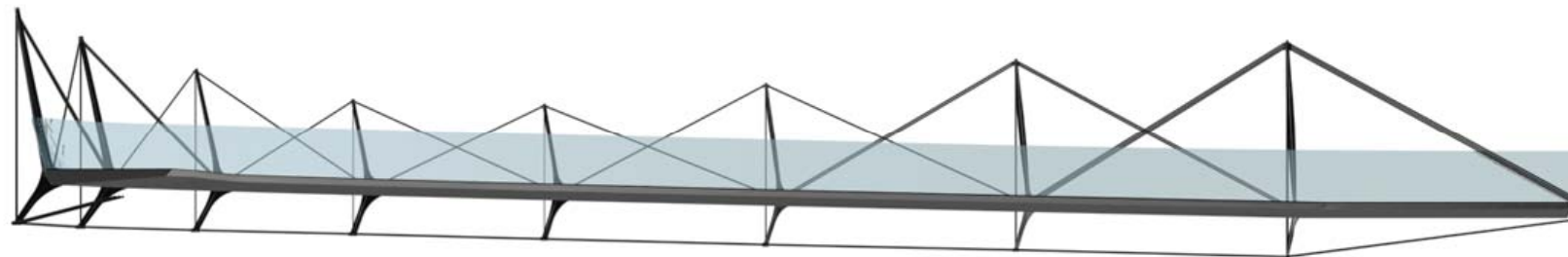
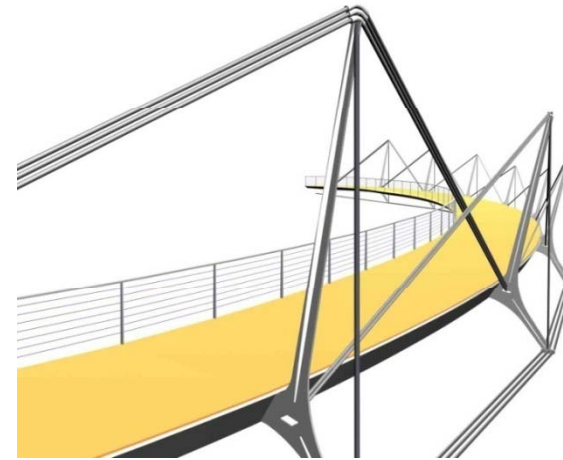
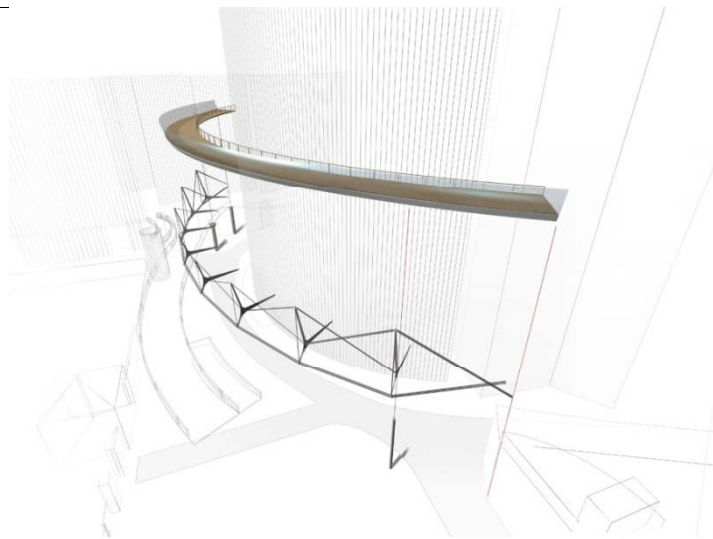

**sbp**  
schlaich  
bergemann partner

zu Konzept 3 - Passerelle La Défense, Paris, Frankreich, 2007



**sbp**  
schlaich  
bergemann partner

zu Konzept 3 - Passerelle La Défense, Paris, Frankreich, 2007



**sbp**  
schlaich  
bergemann partner

zu Konzept 3 - Passerelle La Défense, Paris, Frankreich, 2007

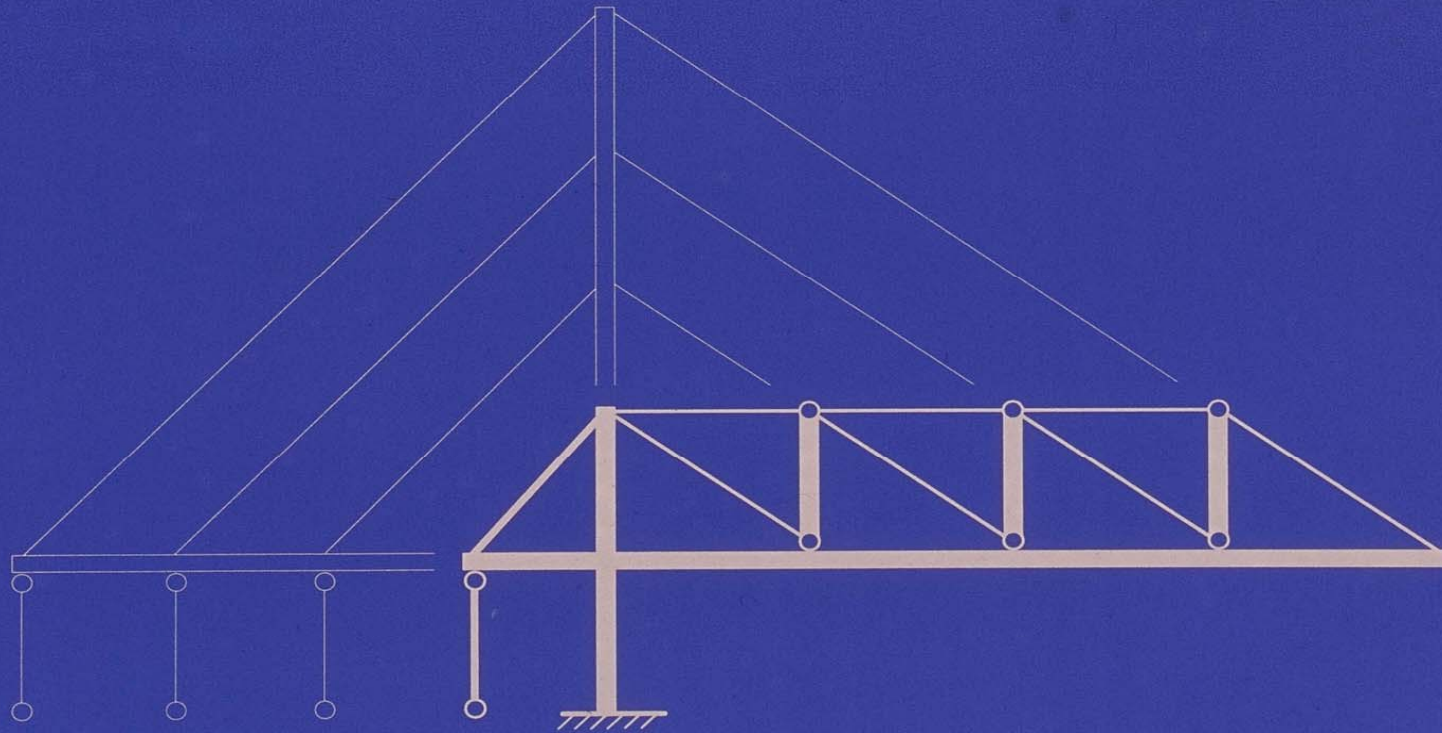



**sbp**  
schlach  
bergemann partner

zu Konzept 3 - EXPO 2000, Hannover, 2000



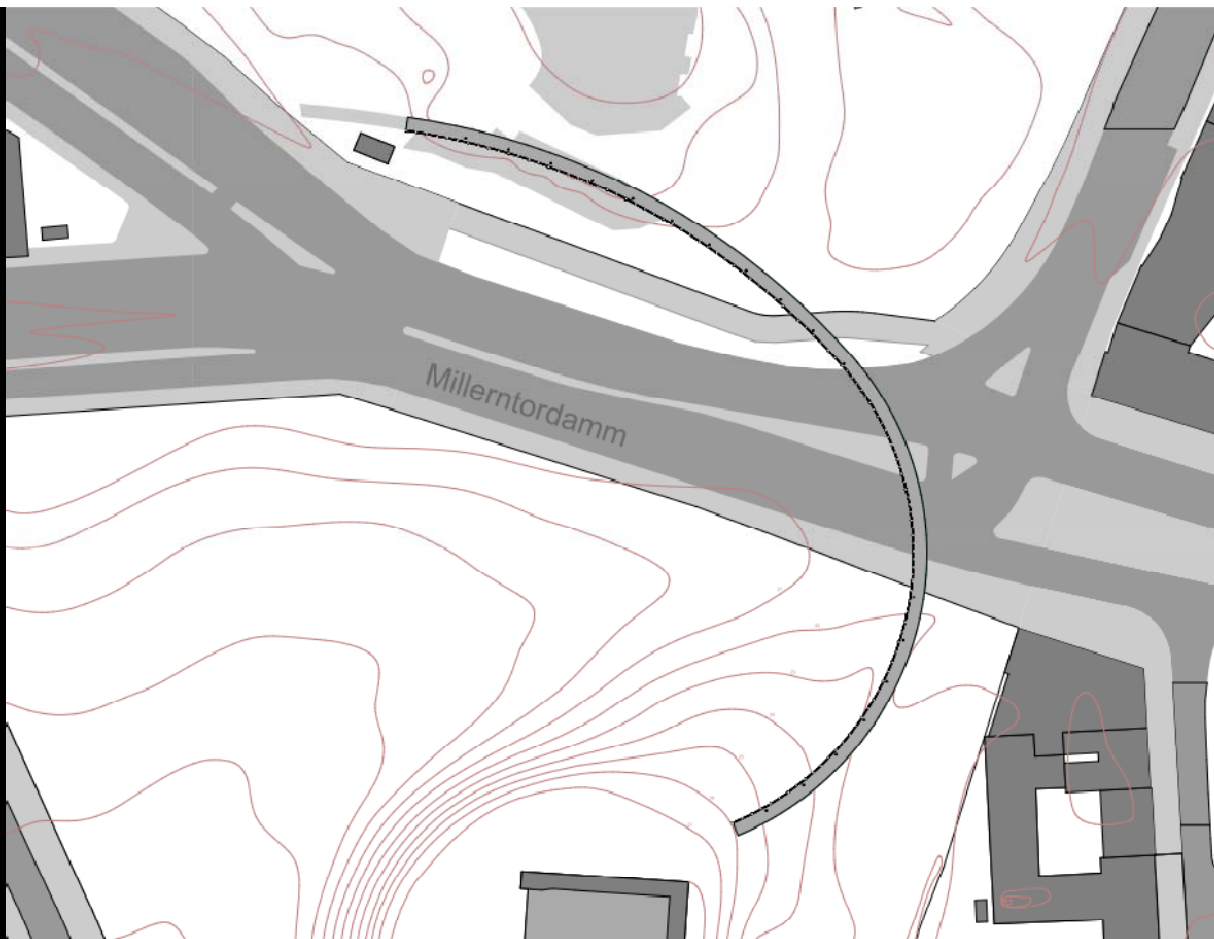



**sbp**  
schleich  
bergemann partner

Konzept 3 – Ring- und Fachwerkträger – Perspektive 1 / Träger 4m hoch



**sbp**  
schlach  
bergemann partner

Konzept 3 – Ring- und Fachwerkträger – Perspektive 1 / Träger 3m hoch





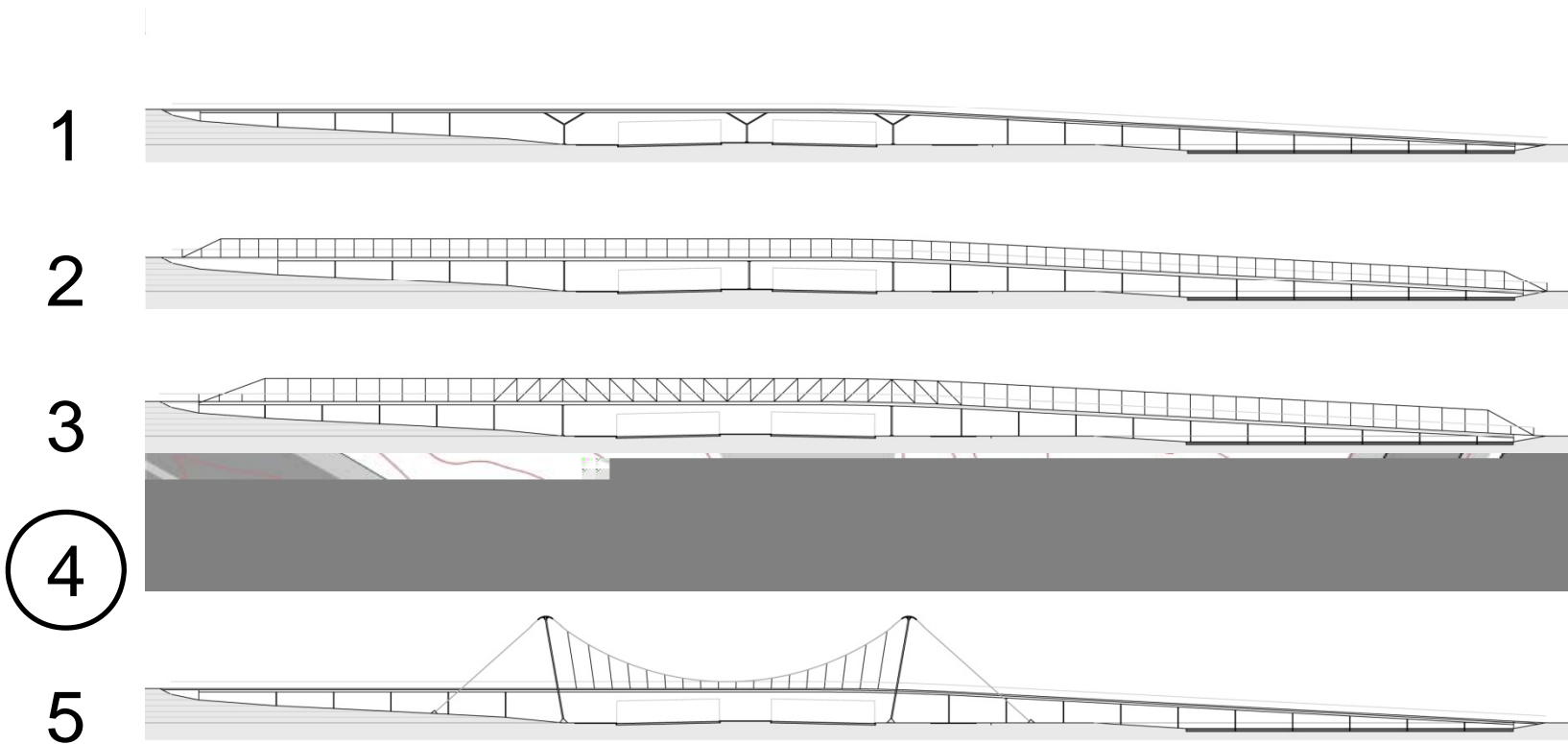



**sbp**  
schlaich  
bergemann partner

zu Konzept 4 - Weinbergbrücke - Bundesgartenschau 2015 Havelregion, Rathenow, 2014



**sbp**  
schlach  
bergemann partner

zu Konzept 4 – Fertigung des Hohlkastens Weinbergbrücke





**sbp**  
schlach  
bergemann partner

zu Konzept 4 – Fertigung Lageranschluss - Weinbergbrücke



**sbp**  
schlach  
bergemann partner

zu Konzept 4 – Montage Weinbergbrücke



**sbp**  
schlach  
bergemann partner

zu Konzept 4 – Weinbergbrücke kurz vor Fertigstellung

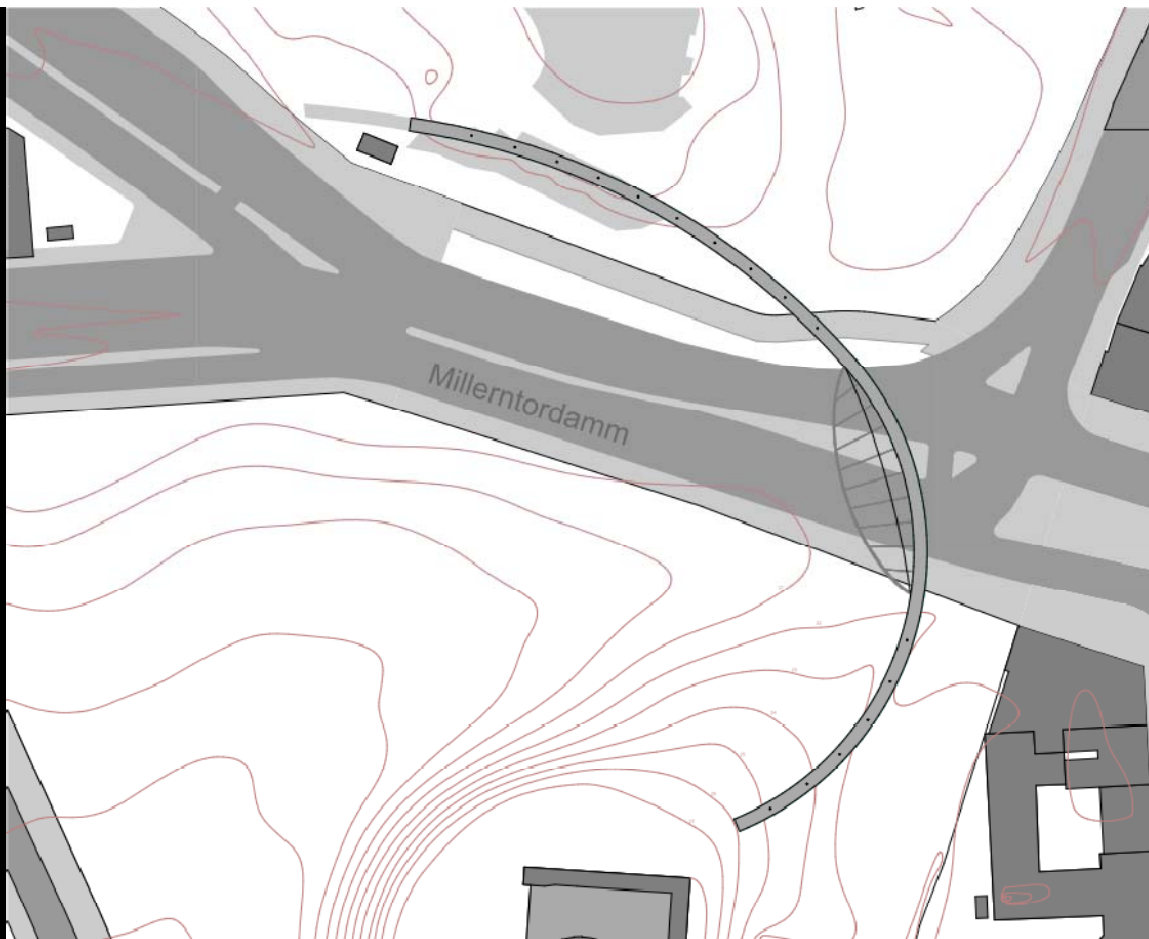



**sbp**  
schleich  
bergemann partner

Konzept 4 – Bogenbrücke – Perspektive 1



**sbp**  
schlach  
bergemann partner

Konzept 4 – Bogenbrücke – Perspektive 2



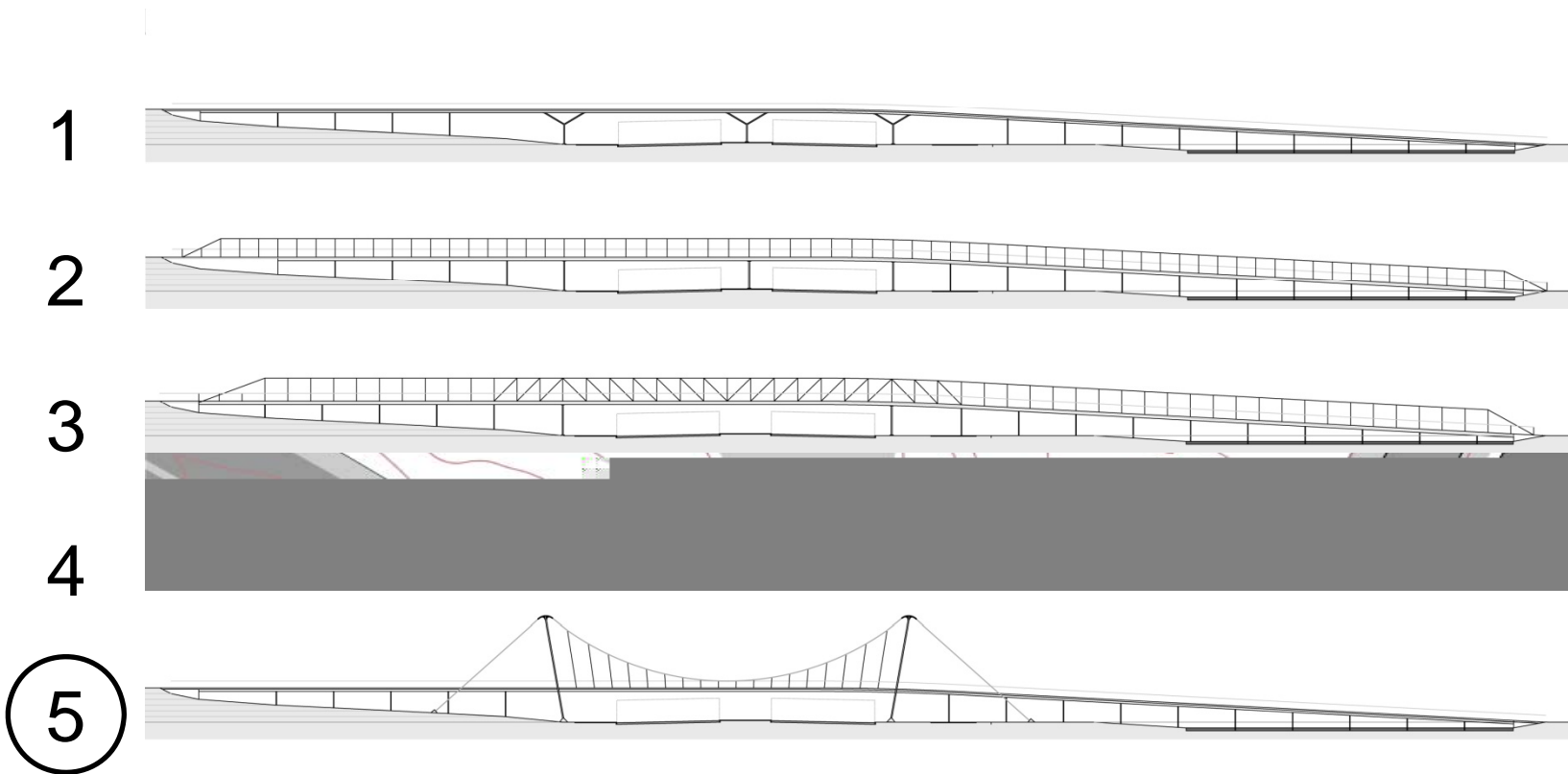





**sbp**  
schlaich  
bergemann partner

zu Konzept 5 - Fußgängerbrücke über den Rhein-Main-Donau-Kanal, Kelheim, 1987



**sbp**  
schlach  
bergemann partner

zu Konzept 5 - Fuß- und Radwegbrücke Hafen Grimberg, Gelsenkirchen, 2009

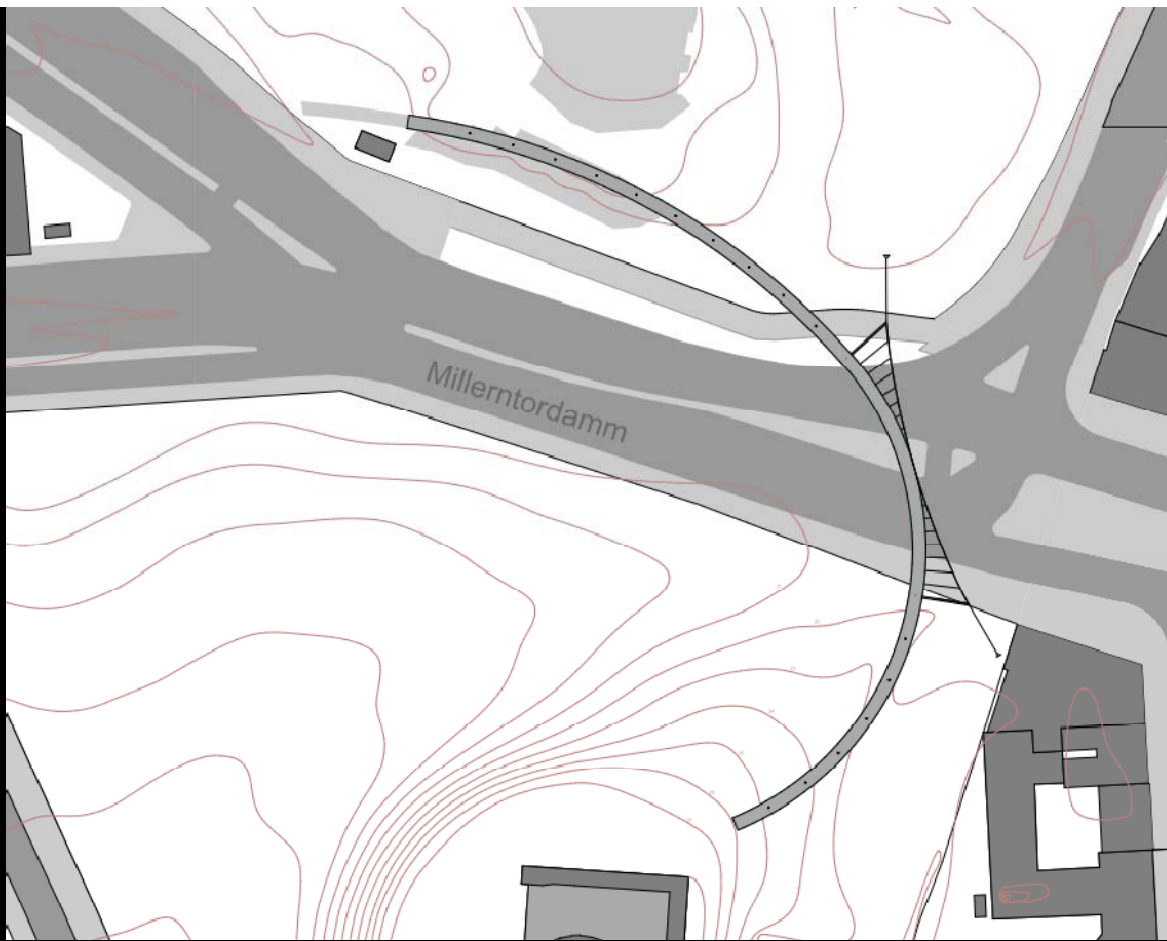



**sbp**  
schleich  
bergemann partner

Konzept 5 – Hängebrücke – Perspektive 1



**sbp**  
schlach  
bergemann partner

Konzept 5 – Hängebrücke – Perspektive 2



1

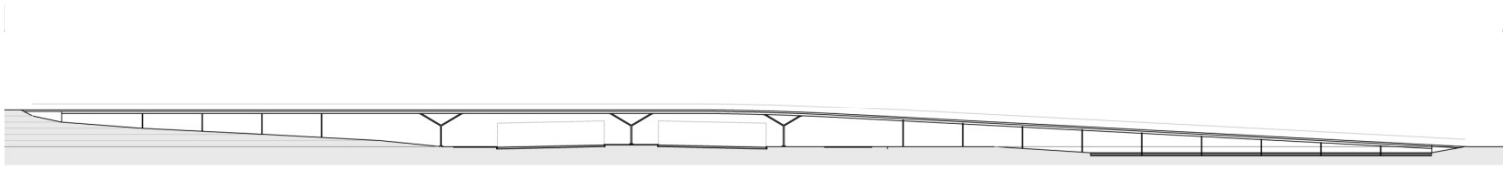

2



3

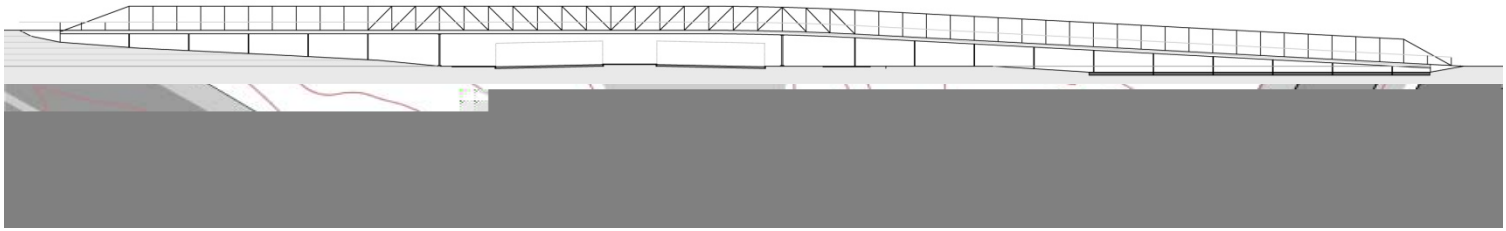

4



5

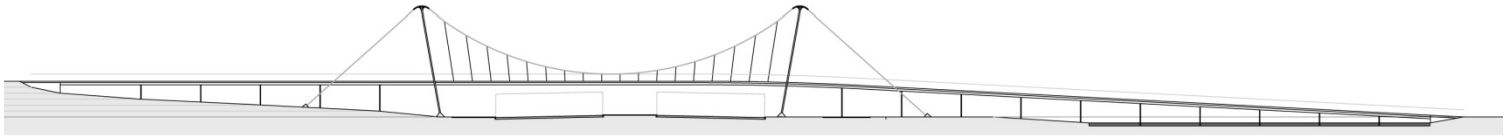

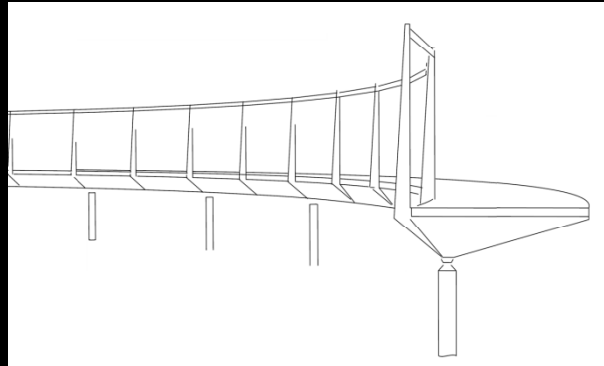

**sbp**  
schlaich  
bergemann partner

Konzeptstudie Brückenschlag Alter Elbpark  
mit Muhs Landschaftsarchitekten für die freie und hansestadt Hamburg



Schwabstraße 43  
70197 Stuttgart  
**stuttgart@sbp.de**

Brunnenstraße 110c  
13355 Berlin  
**berlin@sbp.de**

555 8th Avenue  
Suite #2402  
New York, NY 10018  
**newyork@sbp.de**

1325 Huaihai Road  
Room 804  
Shanghai 200031  
**shanghai@sbp.de**

Rua Afonso Bras  
473 cjs. 113-114  
04511-011 Sao Paulo  
**saopaulo@sbp.de**

52 Boulevard Sébastopol  
75003 Paris  
**paris@sbp.de**

**[www.sbp.de](http://www.sbp.de)**